

Insert collet into s-cam bracket hold collet and turn the shaft to expand it larger than the bushing



Hold collet against the back bushing. drive bushing and seal out the backside



Pull handle against the inside bushing.
Using slide hammer, pull out inner
bushing and seal.



Place new bushing onto driver



Insert short driver handle. Drive bushing into spider until it stops

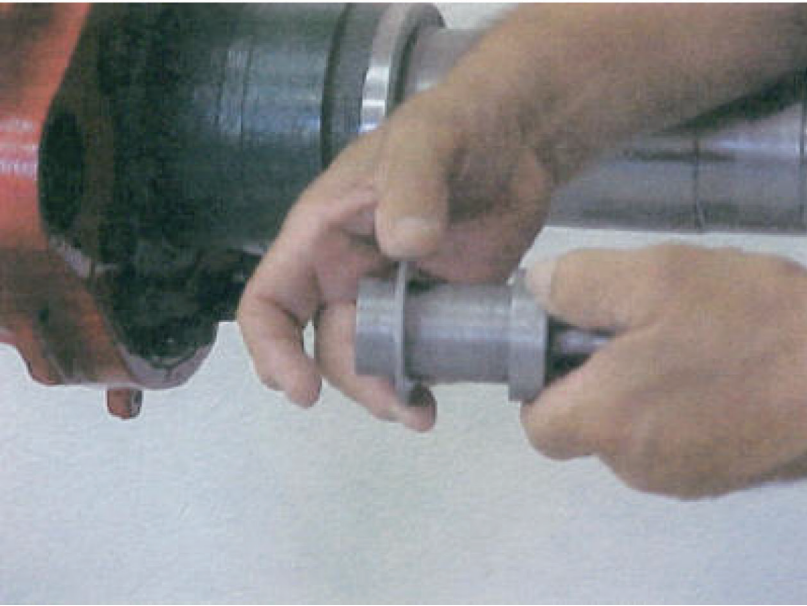

Remove driver and install large washer



Install s-cam seal (lip facing slack adjuster) against the washer. Drive the seal into the spider.



Leave the bushing driver in the bushing as a guide.

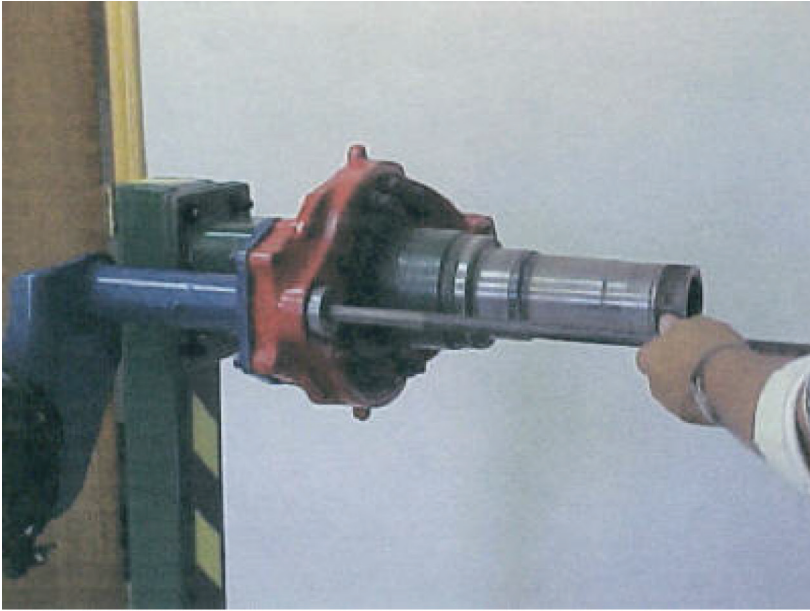

Insert slide hammer shaft into the driver and out the backside of the s-cam bracket

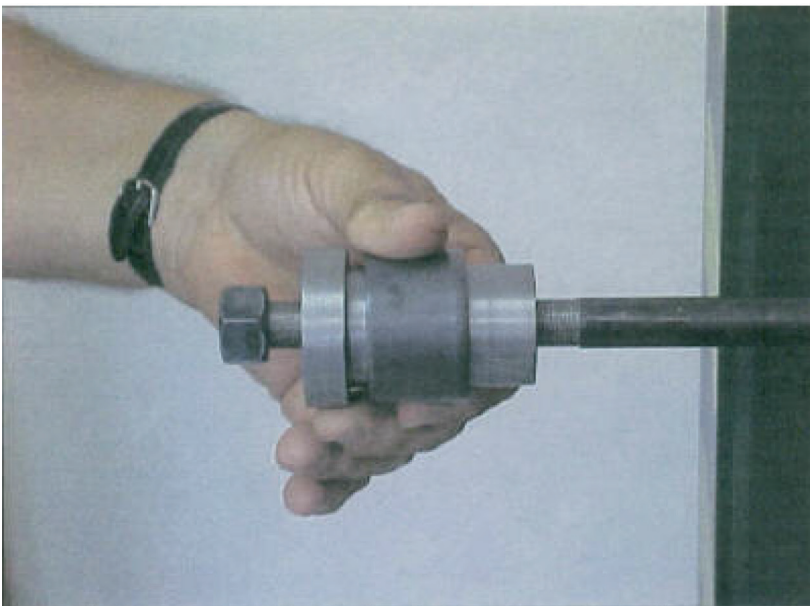

Install new bushing onto the second bushing driver. Secure the nut



Use the slide hammer to pull the bushing into the s-cam bracket until it stops.



Remove the nut and driver, install the large washer and the seal (lip facing the slack adjuster)

Install the driver onto the shaft and secure with the nut.



Use slide hammer to pull the seal into the s-cam bracket in the same manner as the bushing

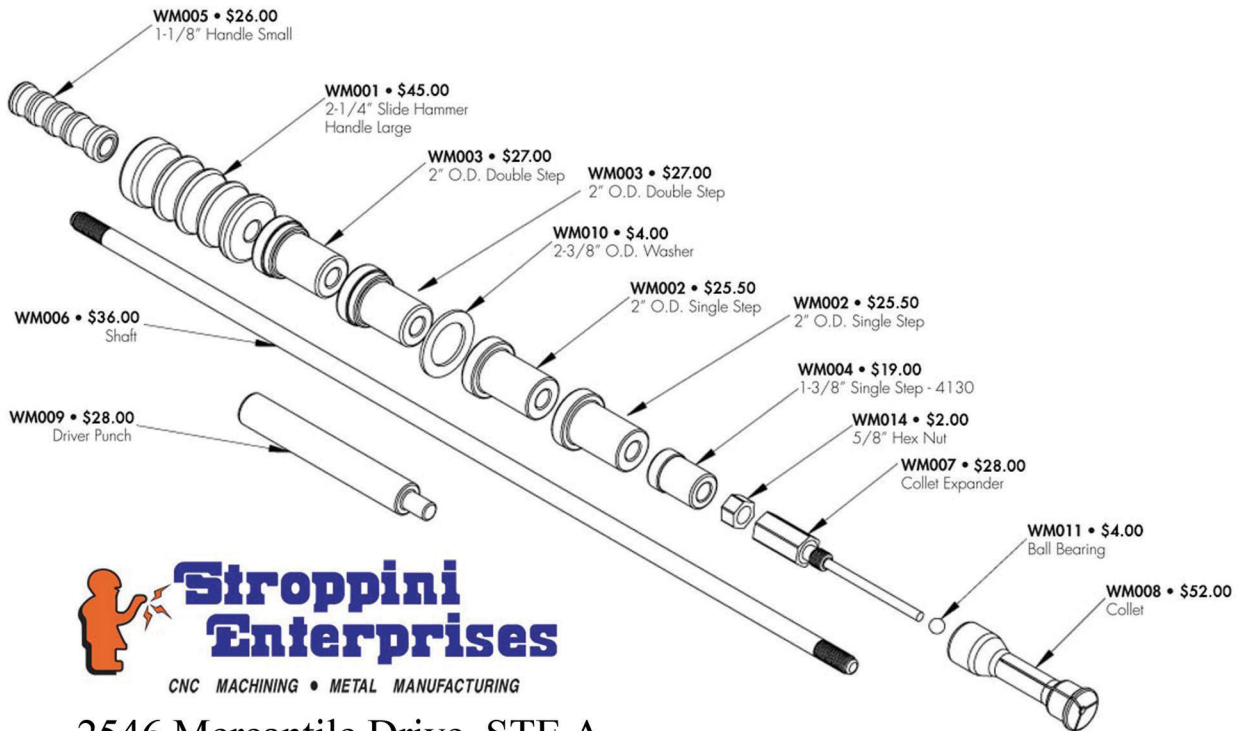

2546 Mercantile Drive, STE A.
 Rancho Cordova, CA 95742
 Phone: 916-635-8181
 Fax: 916-635-8183
WWW.STROPPINI.COM